

CRITERIA FOR THE SEPARATION OF WATER MAINS AND SANITARY SEWERS

Refer to Engineering Standard 6110 for Separation Criteria Text

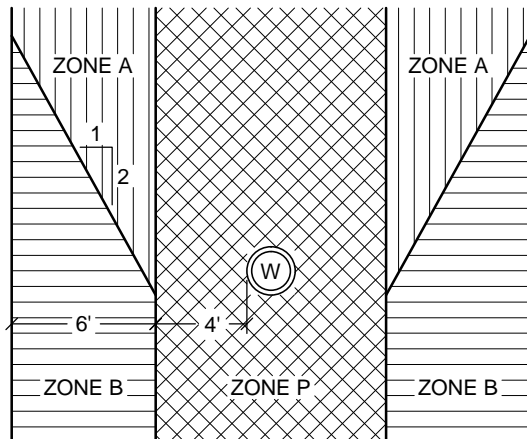

PARALLEL*

*MINIMUM 1' VERTICAL SEPARATION BELOW WATER MAIN WITHIN 10'

NEW SEWER MAIN

Figure 1

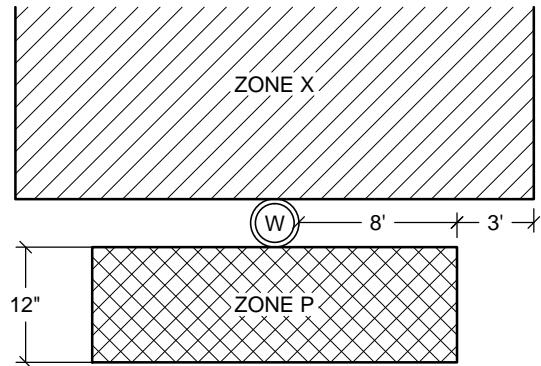

CROSSING

ZONE P is a prohibited zone
 ZONE X requires a state waiver

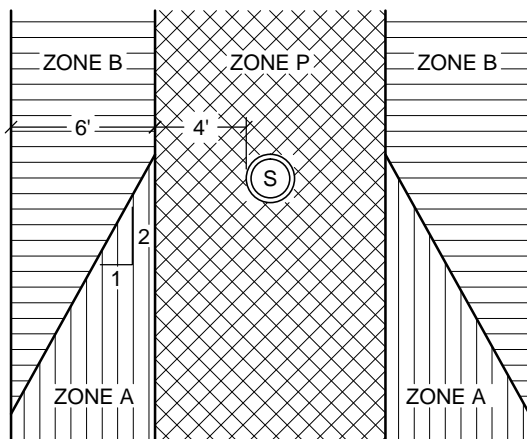

PARALLEL*

*MINIMUM 1' VERTICAL SEPARATION ABOVE SEWER MAIN WITHIN 10'

NEW WATER MAIN

Figure 2

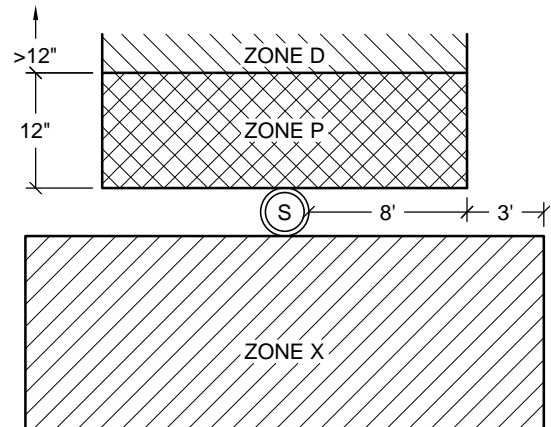

CROSSING

NOTES AND DEFINITIONS

- DIMENSIONS (separation distances) are from the outside of water main to outside of sewer line or manhole.
- FUSED JOINT: The joining of sections of pipe using thermal or chemical bonding processes.
- HEALTH AGENCY: The State Department of Health Services. For those water systems supplying less than 200 service connections, the local health officer shall act for the Department of Health Services.
- HOUSE LATERAL: A sewer pipe connecting the building drain and the main sewer line.
- WATER SUPPLIER: Any person who owns or operates a public water system.

SCALE: N.T.S.

STANDARD CURRENT AS OF: 01/17/2020

APPROVED BY: XX

NOTES:



CAL POLY

WATER - SEWER SEPARATION CRITERIA DETAILS

6140